

Standard series

The Standard series: for the toughest demands.

Robust, solid and ruggedly built, the die-cast zinc Standard series excels in tough everyday situations. Being resistant to shocks, it not only shows its class in terms of its dimensions. The machines in this series can also master larger flow volumes and greater temperature variations with ease.

SERVICE 3 UNIT WITH GAUGE AND ADJUSTING KNOB

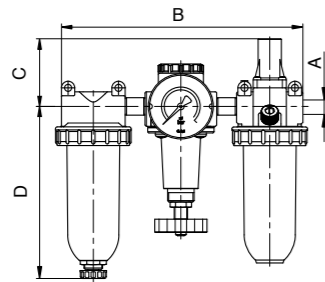

Size	Type	Connection A	Dimensions in mm				Flow rate l/min
			B	C	D		
1	FRO.11 G	G 1/4	168	51	132	600	
1	FRO.12 G	G 3/8	168	51	132	600	
2	FRO.22 G	G 3/8	233	51	145	1400	
2	FRO.23 G	G 1/2	233	51	145	1400	

SERVICE 3 UNIT WITH GAUGE AND CROSSBAR

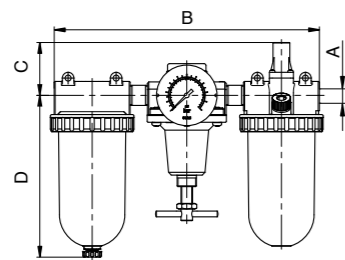

Size	Type	Connection A	Dimensions in mm				Flow rate l/min
			B	C	D		
3	FRO.33 G	G 1/2	276	55	168	3200	
3	FRO.34 G	G 3/4	296	58	168	3200	
3	FRO.35 G	G 1	296	58	168	3200	
5	FRO.54 G	G 3/4	345	61	235	5000	
5	FRO.55 G	G 1	345	61	235	5000	
8	FRO.88 G	G 2	444	77	396	18000	

SERVICE 2 UNIT WITH GAUGE AND ADJUSTING KNOB

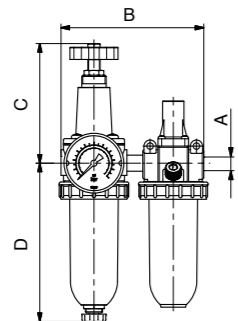

Size	Type	Connection A	Dimensions in mm				Flow rate l/min
			B	C	D		
0	FDO.00 G	G 1/8	85	64	102	350	
0	FDO.01 G	G 1/4	85	64	102	350	
1	FDO.11 G	G 1/4	117	98	132	600	
1	FDO.12 G	G 3/8	117	98	132	600	
2	FDO.22 G	G 3/8	153	116	148	800	
2	FDO.23 G	G 1/2	153	116	148	800	

SERVICE 2 UNIT WITH GAUGE AND CROSSBAR

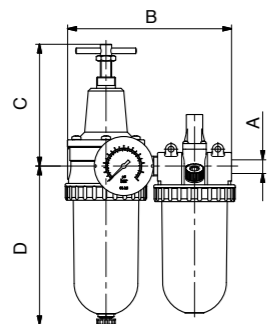

Size	Type	Connection A	Dimensions in mm				Flow rate l/min
			B	C	D		
3	FDO.33 G	G 1/2	175	130	169	2100	
5	FDO.54 G	G 3/4	240	190	263	4000	
5	FDO.55 G	G 1	240	190	263	4000	

FILTERREGULATOR WITH GAUGE AND ADJUSTING KNOB

< 5 µm

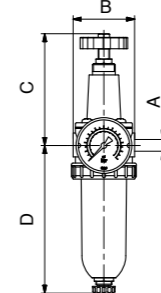

Size	Type	Connection A	Dimensions in mm				Flow rate l/min
			B	C	D		
0	FD.00 G	G 1/8	40	62	102	350	
0	FD.01 G	G 1/4	40	62	102	350	
1	FD.11 G	G 1/4	54	98	132	900	
1	FD.12 G	G 3/8	54	98	132	900	
2	FD.22 G	G 3/8	70	116	148	1500	
2	FD.23 G	G 1/2	70	116	148	1500	

FILTERREGULATOR WITH GAUGE AND CROSSBAR

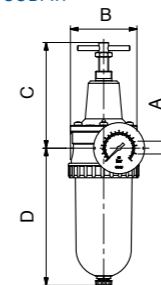

Size	Type	Connection A	Dimensions in mm				Flow rate l/min
			B	C	D		
3	FD.33 G	G 1/2	82	130	169	3000	
5	FD.54 G	G 3/4	117	191	263	7000	
5	FD.55 G	G 1	117	191	263	7000	

PRECISION-FILTERREGULATOR

< 10 µm

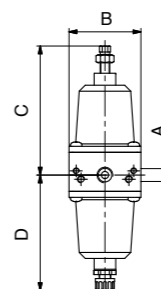

Size	Type	Connection A	Dimensions in mm				Flow rate l/min
			B	C	D		
1	FDP.11	G 1/4	60	108	96	750	
1	FDP.11 NPT	1/4 NPT	60	108	96	750	

LUBRICATOR

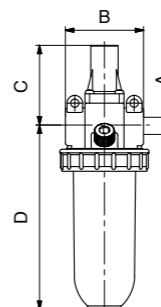

Size	Type	Connection A	Dimensions in mm				Flow rate l/min
			B	C	D		
0	DO.00	G 1/8	40	50	95	650	
0	DO.01	G 1/4	40	50	95	650	
1	DO.11	G 1/4	50	51	118	1200	
1	DO.12	G 3/8	50	51	118	1200	
2	DO.22	G 3/8	70	51	130	2400	
2	DO.23	G 1/2	70	51	130	2400	
3	DO.33	G 1/2	90	58	160	4000	
3	DO.34	G 3/4	90	58	160	9000	
3	DO.35	G 1	90	58	160	9000	

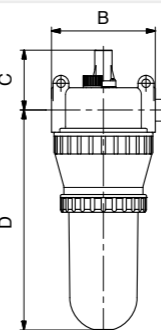

Size	Type	Connection A	Dimensions in mm				Flow rate l/min
			B	C	D		
5	DO.54	G 3/4	105	61	223	9000	
5	DO.55	G 1	105	61	223	9000	
5	DO.57	G 1 1/2	125	70	232	9000	
8	DO.86	G 1 1/4	150	77	383	11000	
8	DO.87	G 1 1/2	150	77	383	11000	
8	DO.88	G 2	150	77	383	11000	

FILTER

< 5 µm

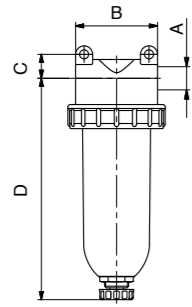

Size	Type	Connection A	Dimensions in mm			Flow rate l/min
			B	C	D	
0	DF.00	G 1/8	40	10	102	800
0	DF.01	G 1/4	40	10	102	800
1	DF.11	G 1/4	48	14	132	800
1	DF.12	G 3/8	48	14	132	800
2	DF.22	G 3/8	69	16	145	3100
2	DF.23	G 1/2	69	16	145	3100
3	DF.33	G 1/2	79	18	170	4000
3	DF.34	G 3/4	90	26.5	172	4000
3	DF.35	G 1	90	26.5	172	4000

< 60 µm

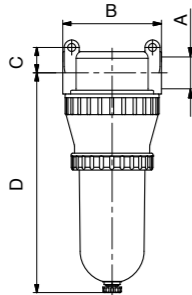

5	DF.54	G 3/4	105	27	235	12500
5	DF.55	G 1	105	27	235	12500
5	DF.56	G 1 1/4	125	36.5	245	12500
5	DF.57	G 1 1/2	125	36.5	245	12500
8	DF.86	G 1 1/4	148	41	396	30000
8	DF.87	G 1 1/2	148	41	396	30000
8	DF.88	G 2	148	41	396	30000
9	DF.98	G 2 1/2	160	57	410	40000
9	DF.99	G 3	160	57	410	40000

PREFILTER < 0.3 µm METAL BOWL

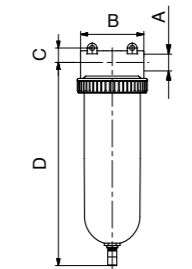

3	DFV.33 M AM	G 1/2	79	18	254	1330
5	DFV.55 M AM	G 1	105	27	335	3670
8	DFV.87 M AM	G 1 1/2	148	41	658	7000
8	DFV.88 M AM	G 2	148	41	658	7000

FINEFILTER 0.01 µm METAL BOWL

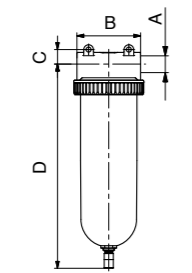

3	DFX.33 M AM	G 1/2	79	18	254	1250
5	DFX.55 M AM	G 1	105	27	335	7000
8	DFX.87 M AM	G 1 1/2	148	41	658	14000
8	DFX.88 M AM	G 2	148	41	658	14000

ACTIVATED-CARBON FILTER¹⁾

REMAINING OIL CONTENT < 0.005 mg/m³

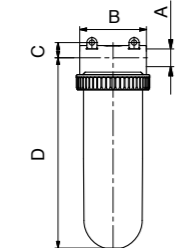

3	DFA.33 M	G 1/2	79	18	226	2500
5	DFA.55 M	G 1	105	27	307	10000
8	DFA.87 M	G 1 1/2	148	41	630	14000
8	DFA.88 M	G 2	148	41	630	14000

¹⁾ only with finefilter type DFX

REGULATOR WITH ADJUSTING KNOB

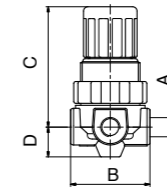

Size	Type	Connection A	Dimensions in mm			Flow rate l/min
			B	C	D	
0	DR.032 S	LW 6	46.5	69	4	280
0	KDR.00 S	G 1/8	30	56	8	360
0	KDR.FL	Flange	30	64	-	370
0	DR.022-00 G	G 1/8	43	61	10	340
0	DR.022-01 G	G 1/4	43	61	10	340

REGULATOR FOR BRAKE FLUID

0	DR.00 B	G 1/8	40	61	15	300
0	DR.01 B	G 1/4	40	61	15	300

REGULATOR FOR WATER

0	DR.021-00 ²⁾	G 1/8	40	61	15	300
0	DR.021-01 ²⁾	G 1/4	40	61	15	300

REGULATOR FOR OXYGEN

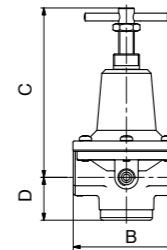

0	DR.00 mO	G 1/8	40	63	15	330
0	DR.01 mO	G 1/4	40	63	15	330
3	DR.33 O	G 1/2	82	130	33	5000
5	DR.55 O	G 1	117	190	48	11000

REGULATOR WITH GAUGE AND ADJUSTING KNOB

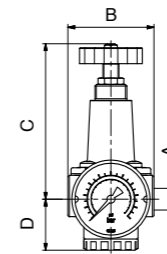

0	DR.00 G	G 1/8	40	63	15	330
0	DR.01 G	G 1/4	40	63	15	330
1	DR.11 G	G 1/4	54	97	32	1000
1	DR.12 G	G 3/8	54	97	32	1000
2	DR.22 G	G 3/8	70	112	34	2200
2	DR.23 G	G 1/2	70	112	34	2200

REGULATOR WITH GAUGE AND CROSSBAR

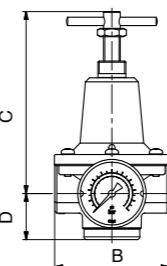

3	DR.33 G	G 1/2	82	130	33	5000
3	DR.34 G	G 3/4	90	130	33	5000
3	DR.35 G	G 1	90	130	33	5000
5	DR.54 G	G 3/4	117	190	48	11000
5	DR.55 G	G 1	117	190	48	11000
7	DR.76 G	G 1 1/4	118.5	201	52	16500
7	DR.77 G	G 1 1/2	118.5	201	52	16500

²⁾ medium: water, compressed air, non corrosive gases

REGULATOR WITH GAUGE, PILOT-OPERATED

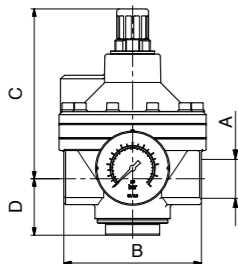

Size	Type	Connection A	Dimensions in mm				Flow rate l/min
			B	C	D		
5	DRP.54 G	G 3/4	117	144	48	15000	
5	DRP.55 G	G 1	117	144	48	15000	
7	DRP.76 G	G 1 1/4	119	154	52	40000	
7	DRP.77 G	G 1 1/2	119	154	52	40000	
8	DRP.87 G	G 1 1/2	160	157	106	50000	
8	DRP.88 G	G 2	160	157	106	50000	

REGULATOR WITH GAUGE, PNEUMATIC PILOT-OPERATED

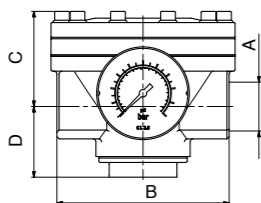

3	DRI.33	G 1/2	82	35	33	5000
5	DRI.54	G 3/4	117	65	48	11000
5	DRI.55	G 1	117	65	48	11000
7	DRI.76	G 1 1/4	119	73	53	16500
7	DRI.77	G 1 1/2	119	73	53	16500
8	DRI.87	G 1 1/2	160	92	106	50000
8	DRI.88	G 2	160	92	106	50000

REGULATOR STAINLESS STEEL

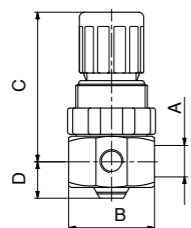

0	XDR.01	G 1/4	36	62	16	320
0	XXDR.01	G 1/4	36	62	16	320

PRECISION REGULATOR

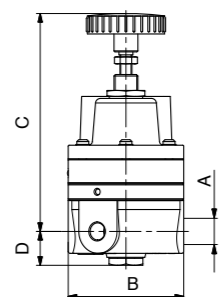

1	FDR.04	G 1/4	57	100	14	400
1	FDR.02	G 1/4	58	109	17	950
1	FDR.11	G 1/4	60	114	32	750
1	FDR.11 NPT	1/4 NPT	60	114	32	750
3	DRF.31	G 1/4	82	135	19	550
3	FDR.03-31 ³⁾	G 1/4	82	160	44	6000
3	FDR.03-32 ³⁾	G 3/8	82	160	44	6000
3	FDR.03-33 ³⁾	G 1/2	82	160	44	6000

PRECISION REGULATOR PNEUMATIC PILOT OPERATED

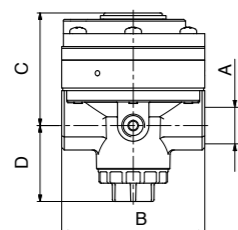

3	FDRI.03-31	G 1/4	82	65.5	44	6000
3	FDRI.03-32	G 3/8	82	65.5	44	6000
3	FDRI.03-33	G 1/2	82	65.5	44	6000

ACCESSORIES SERIES 0, 1, 2, 3, 4, 5, 7, 8

Spring BG0	Spring BG1	Spring BG2	Spring BG3	Spring BG5+BG7	Control panel nut BG0 M30 x 1,5
0.1-3: DR.00-21 0.5-6: DR.00-19 0.5-16: DR.00-20	0.1-3: DR.11-32 0.5-6: DR.11-15 0.5-16: DR.11-12	0.1-3: DR.22-4 0.5-6: DR.22-5 0.5-16: DR.22-7	0.1-3: DR.33-9 0.5-6: DR.33-35 0.5-16: DR.33-12	0.1-3: DR.55-29 0.5-6: DR.55-30 0.5-16: DR.55-28v	0.1-3: C.11-81 0.5-6: C.11-82 0.5-16: C.11-66
0.1-3: DR.00-21 0.5-6: DR.00-19 0.5-16: DR.00-20	0.1-3: DR.11-32 0.5-6: DR.11-15 0.5-16: DR.11-12	0.1-3: DR.22-4 0.5-6: DR.22-5 0.5-16: DR.22-7	0.1-3: DR.33-9 0.5-6: DR.33-35 0.5-16: DR.33-12	0.1-3: DR.55-29 0.5-6: DR.55-30 0.5-16: DR.55-28v	0.1-3: C.11-81 0.5-6: C.11-82 0.5-16: C.11-66
Control panel nut BG0 M30 x 1,5	Control panel nut BG1-3 M20 x 1,5	Mounting bracket BG0-2	Mounting bracket BG0-2	Metal bowl BG0 with drain	Metal bowl with drain
DR.00-34	DR.11-7	BG0: WH.M30 BG1-2: WH.M20	BG1: BW.10 BG2: BW.20 BG3: BW.30 BG5+7: BW.50	C.00 M HA	BG1: DF.11 M BG2: DF.22 M BG3-8: DF.33 M
Metal oil bowl closed	Bowl guard				
BG0: L.00 M BG1: DO.11 M BG2: DO.22 M BG3-8: DO.33 M	BG1: DF.11-35 BG2: DF.22-11 BG3-8: DF.33-11				

ACCESSORIES

Gauge BG0	Gauge BG1, BG2, BG8	Gauge BG3, BG5, BG7	Differential pressure gauge BG8	Auto drain
G 40.4 R G 40.6 R G 40.10 R G 40.16 R	G 50.4 R G 50.6 R G 50.10 R G 50.16 R	G 63.6 R G 63.10 R G 63.16 R G 63.25 R	Type DM 2	Type AM 10 Type AM 10 NC

3) high venting capacity

Futura series and Multi-Fix series – a selection from the full range.

Equipment	Futura series Connection size	Multi-Fix series Connection size
Filter	G 1/8 to G 1	G 1/8 to G 1
Prefilter 0.3 µm	G 1/8 to G 1	G 1/2 to G 1
Finefilter 0.01 µm	G 1/8 to G 1	G 1/2 to G 1
Activated-carbon filter	G 1/8 to G 1	G 1/2 to G 1
Vacuumfilter	G 1/2	G 1/2
Regulator	G 1/8 to G 1	G 1/4 to G 1
Regulator pneumatic pilot-operated	G 1/4 to G 1	G 1/2 to G 2
Regulator with continuous pressure supply	G 1/4 to G 1/2	G 1/4 to G 1/2
Regulator with gauge inside the setting knob	G 1/4 to G 3/8	G 1/4 to G 3/8
Regulator with continuous P and gauge inside the setting knob	G 1/4 to G 3/8	G 1/4
Regulator for water	÷	G 1/4
Precision-regulator	G 1/4 to G 1/2	G 1/4 to G 1/2
Filter regulator for compressed air and neutral gases	G 1/8 to G 1	G 1/8 to G 1
Precision-filter-regulator	÷	G 1/4, G 1/2
Lubricator	G 1/4 to G 1	G 1/4 to G 1
Micro-dosing lubricator	G 1/8 to G 1/2	G 1/8 to G 1/2
Service 3 unit	G 1/8 to G 1	G 1/8 to G 1
Service 2 unit	G 1/8 to G 1	G 1/8 to G 1
3/2 directional-control valve	G 1/4 to G 1	G 1/4 to G 1
Starting valve	G 1/4 to G 1	G 1/4 to G 1
Ball valve	G 1/8 to G 1	G 1/8 to G 3/4
Non-return valve	G 1/4 to G 1	G 1/4 to G 3/4
Distributor block	G 1/4 to G 1	G 1/4 to G 3/4
Diaphragm-type dryer	G 1/4 to G 1/2	G 1/4 to G 1/2
The individual devices of Futura and Multi-Fix series can be easily connected in any order with coupling kits.		
Special devices		Connection size
Central-filter-lubricator unit		G 1 to G 2